

STEP BY STEP GUIDE ON HOW TO USE

① Avoid essential oil or acetone chemicals dropping on the iron shell.

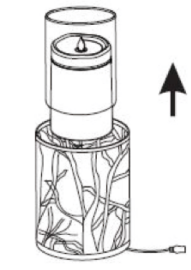

② Remove the splash guard lid.



③ a. Fill the water tank
b. Do not exceed maximum water level. Add your chosen essential oil, 5-10 drops depending on your required intensity.



④ Replace the splash guard lid and glass cover.

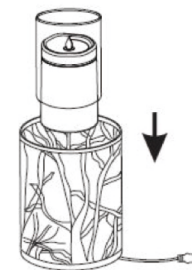

⑤ Plug the adaptor into a power outlet.

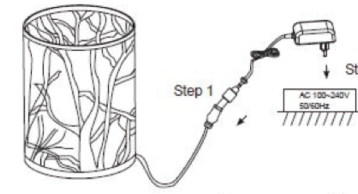

⑥ Press the power button to start the machine.

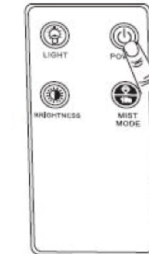

MAINTENANCE

1. Always unplug the device before performing any maintenance first removing from the wall outlet and then unplug the DC jack end.
2. Gently remove any possible mineral deposits from the mist outlet and the ceramic disc. Use a small cotton swab/ear bud or soft cloth. Neither the mist outlet nor the ceramic plate should come into contact with any hard objects.
3. Rinse the device with clean water and dry completely with a soft cloth before storing.
4. Change water daily when using frequently.
5. Do not use any liquid solvents to clean the electronic components as they may damage the unit.

WARNING

In case of any abnormal observations such as smoke, peculiar smells or noise, stop using the unit immediately to avoid the risk of an accident such as fire or electric shock. You should unplug the adaptor immediately and contact your local dealer. Never wrap the adaptor or Aroma Diffuser with cloth or paper, as blocking the ventilation could increase the risk of a fire. Never attempt to disassemble or repair the product. In case of internal inspection or repair becoming necessary, please contact your local dealer. Please keep the product out of the reach of children to avoid risk of any Injury. Your Aroma Diffuser should be cleaned regularly and kept clean and dry when not in use.

IMPORTANT!

Corrosive oils such as Citronella may cause damage to the ceramic disc if left in the reservoir when not operating the unit. This type of damage will not be covered under the warranty. This Aroma Diffuser must be cleaned after each use.

ONE YEAR WARRANTY

This SCENTWORKS limited warranty does not cover any damage, deterioration or malfunction resulting from any alteration, modification, improper use or maintenance, misuse, accident, exposure to excess moisture, fire, lightning, power surges, or other acts of nature.

This limited warranty lasts for one (1) year from the date of original purchase of this product. In order to pursue any remedy under this limited warranty, please visit www.scentworks.co.za/warranty or email warranty@scentworks.co.za with your name, contact details and a copy of your receipt. Only registered warranties will be accepted in case of returns, malfunctions and other claims for your device.

Scentworks Pty Ltd at its sole option, will provide one of the following three;

1. Elect to repair or facilitate the repair of any defective parts within a reasonable period of time, free of any charge for the necessary parts and labour to complete the repair and restore this product to its proper operating condition.
2. Replace this product with a direct replacement or with a similar product deemed by ourselves to perform substantially the same function as the original product.
3. Issue a refund of the original purchase price less depreciation to be determined based on the age of the product at the time remedy is sought under this limited warranty.

The maximum liability under this warranty is the retail purchase price paid for this item.

AURA

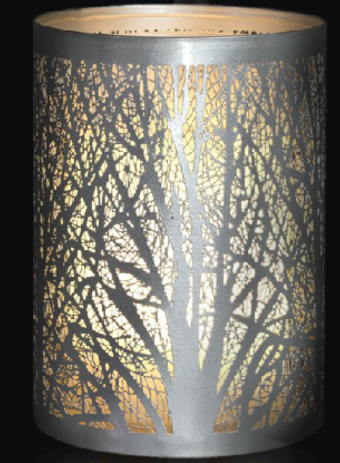

REFLECTION

REFLECTION

LUXURIOUS SCENT DIFFUSER

The AURA Reflection diffuser effortlessly scents any room. It has an easy to use remote control. This beautifully crafted piece features both metal and glass which will compliment any space. In addition to the light mode the device has a candle flicker option.

The Reflection ultrasonic oil diffuser uses ultrasonic technology to turn water and essential oils into fine micro-particles, diffusing aroma as mist without heat. Since this process of diffusing essential oils is smokeless and heatless the purity and health benefits of these oils remain intact.

Simply add a few drops of your favourite fragrance oil into the water filled reservoir, replace the cover and push the buttons to control mist intensity and light. Auto shut off feature gives you peace of mind.

SCENTWORKS (PTY) LTD

74 Kyalami Boulevard, Kyalami Business Park, Midrand, Gauteng, South Africa
info@scentworks.co.za
www.scentworks.co.za

SPECIFICATIONS

Item No.: AURA Reflection
Product Size: 118 x 166mm
Voltage: DC 24V
Power: 12W
Water Capacity: 110ml
Run time: Over 3 hours continuous, up to 6 hours intermittent

FEATURES

Warm white light with On/Off function
Ideal for use with essential oils
Auto Shut off safety feature
Mini Humidifier
Easy to clean
Low energy consumption

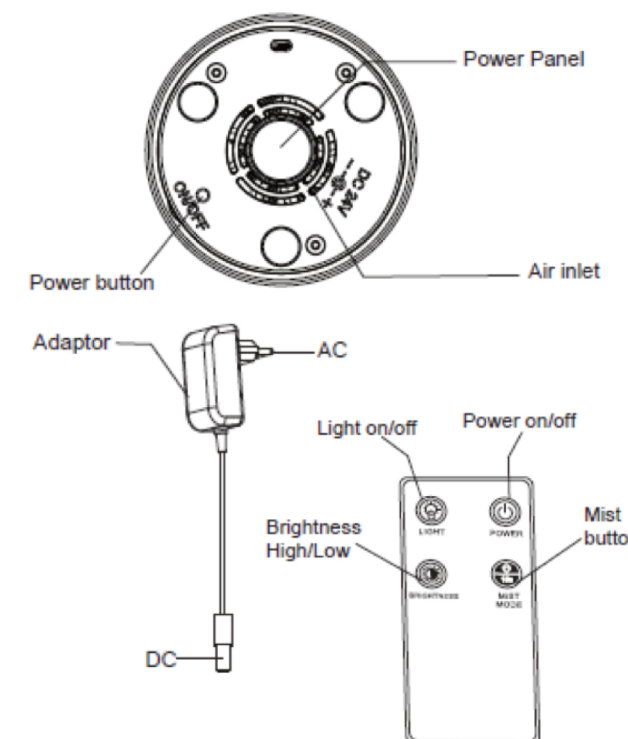
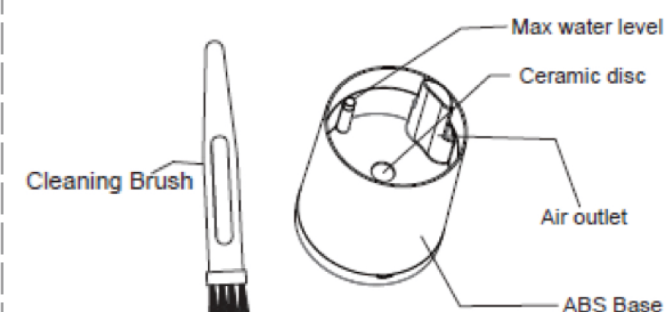
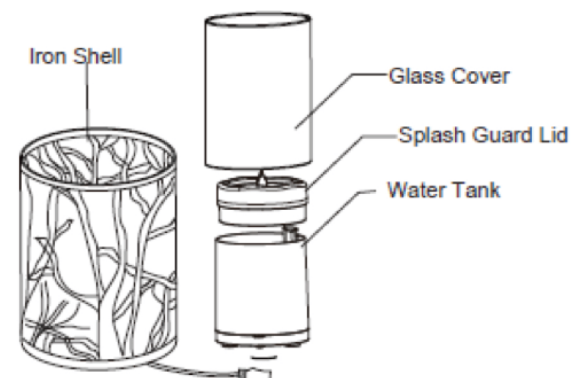

OPERATING PROCEDURE

IMPORTANT NOTES BEFORE USE:

CAUTION

- Do not operate the device without water.

• Avoid any spillage of water by keeping the unit upright at all times and make sure it is on a flat surface.

• Make sure the water tank is emptied when the device is not in use. Pour the water out from the side of the machine, avoid pouring by the air outlet.

• Should any spillage occur please wipe up immediately.

• Corrosive oils such as Citronella may cause damage to the ceramic plate if left in the water tank when not operating the unit. To avoid this please ensure you do not leave water in the device when it is not operating.

REMOTE CONTROL

Main Power Button

1. Press once to switch on light, mist and air fan all on continuous mode. After 3 hours the device will automatically shut off.
2. Press for a second time and the machine will switch off.

Light Button

1. Press once to switch the light on with maximum brightness.
2. Press for a second time to change the light to 'candle mode'.
3. Press a third time to turn the light off.

Mist Button

1. Press once for intermittent mist for a run time of up to 6 hours.
2. Press twice for continuous mist for a run time of 3 hours.

Light Button

1. Press once for low brightness.
2. Press twice for higher brightness.

POWER BUTTON ON BASE OF DEVICE

1. Press once to switch on light, mist and air fan all on continuous mode. After 3 hours the device will automatically shut off.
2. Press a second time for intermittent mist mode, 15 seconds on, 15 seconds off working for up to 6 hours.
3. Press a 3rd time to switch the machine off.